

2nd Floor-Lounge-Bar
Historic Courthouse 1893

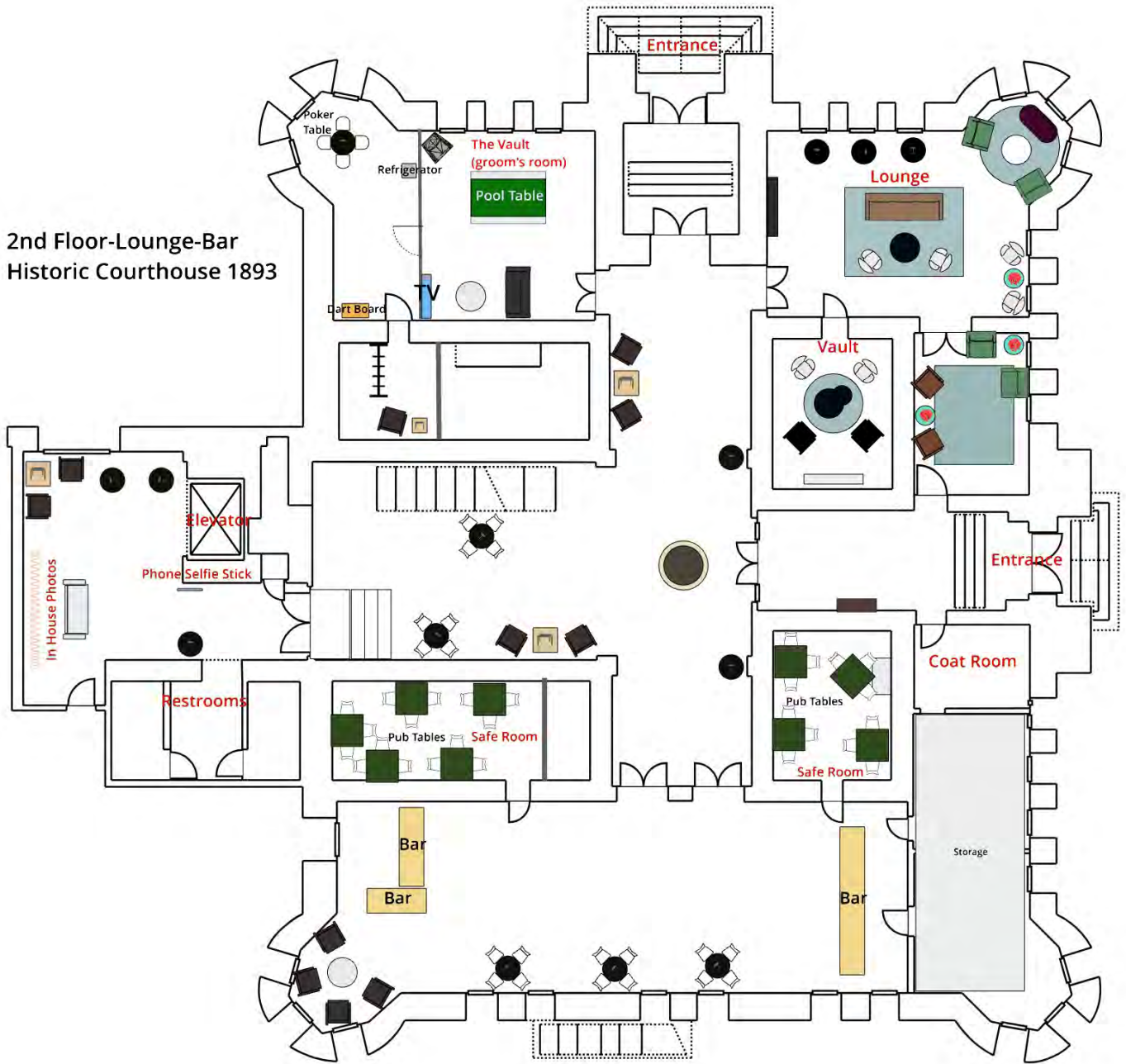

10 Feet

14-60" rounds set 8=112

Head Table Set=14

Minimum Chairs=126

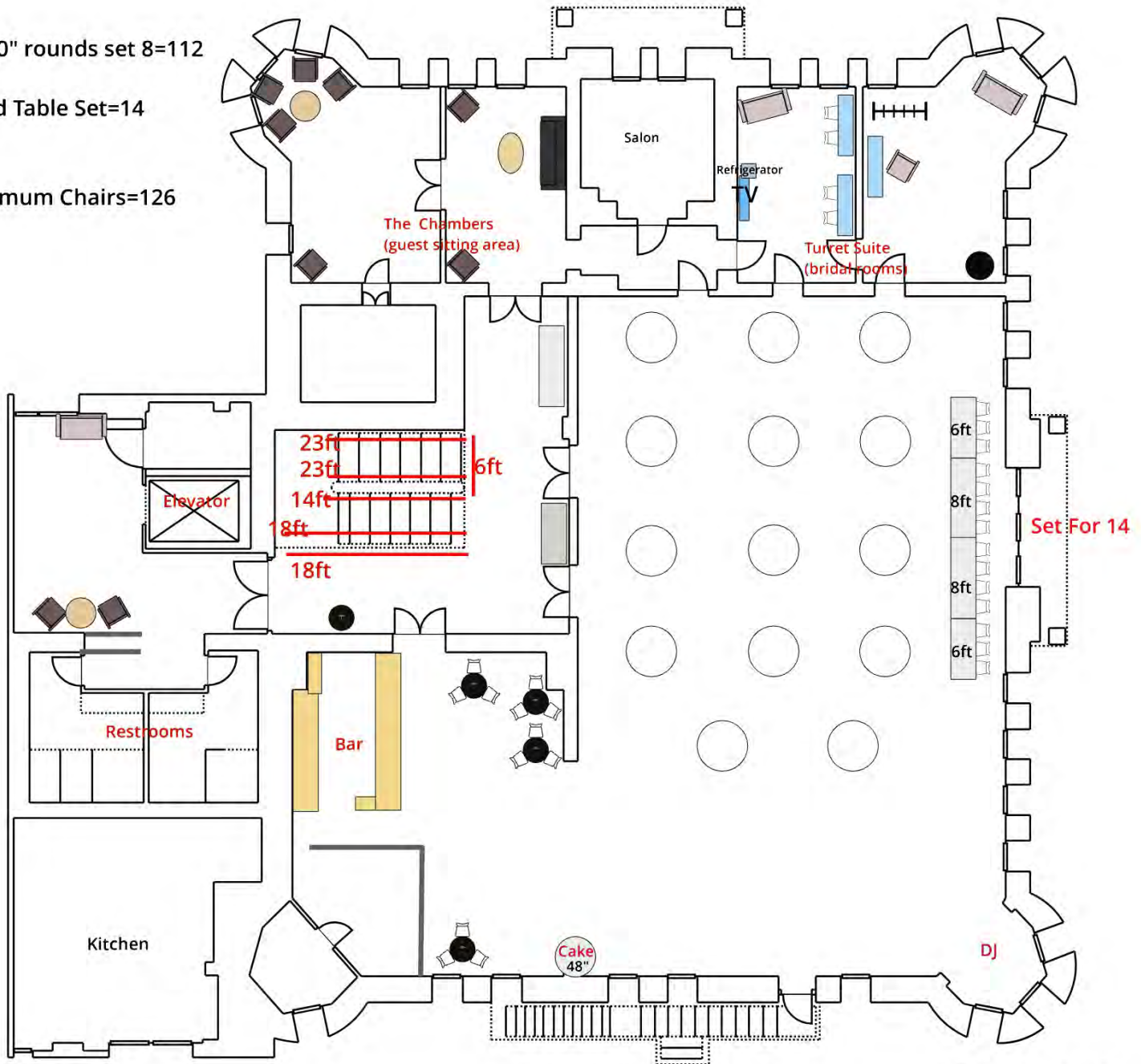

○ =Round 60"
(set 8-10)

10 Feet

14-60" rounds set 8=112

Head Table Set=14

Minimum Chairs=126

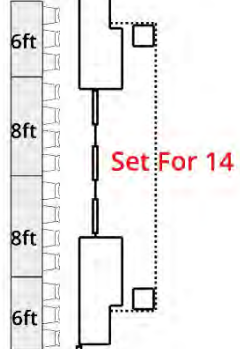
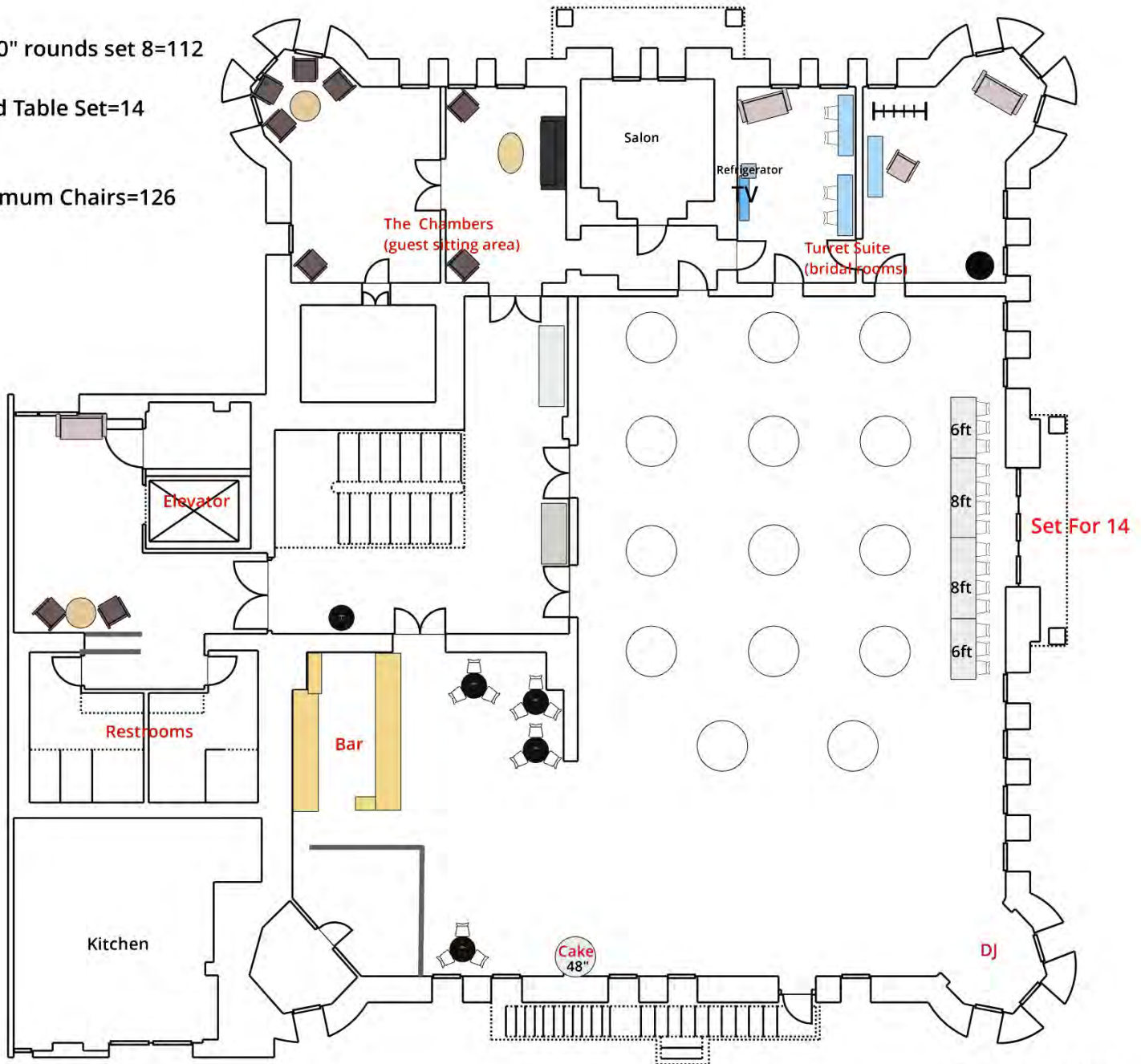

○ =Round 60" (set 8-10)

10 Feet

10-72" rounds set 12=120
(or set 10=100)

16-60" rounds set 10=160
(or set 8=128)

Head Table Set=2

Maximum Chairs=282
Minimum Chairs=230

Tables may vary slightly from diagram for maximum comfort

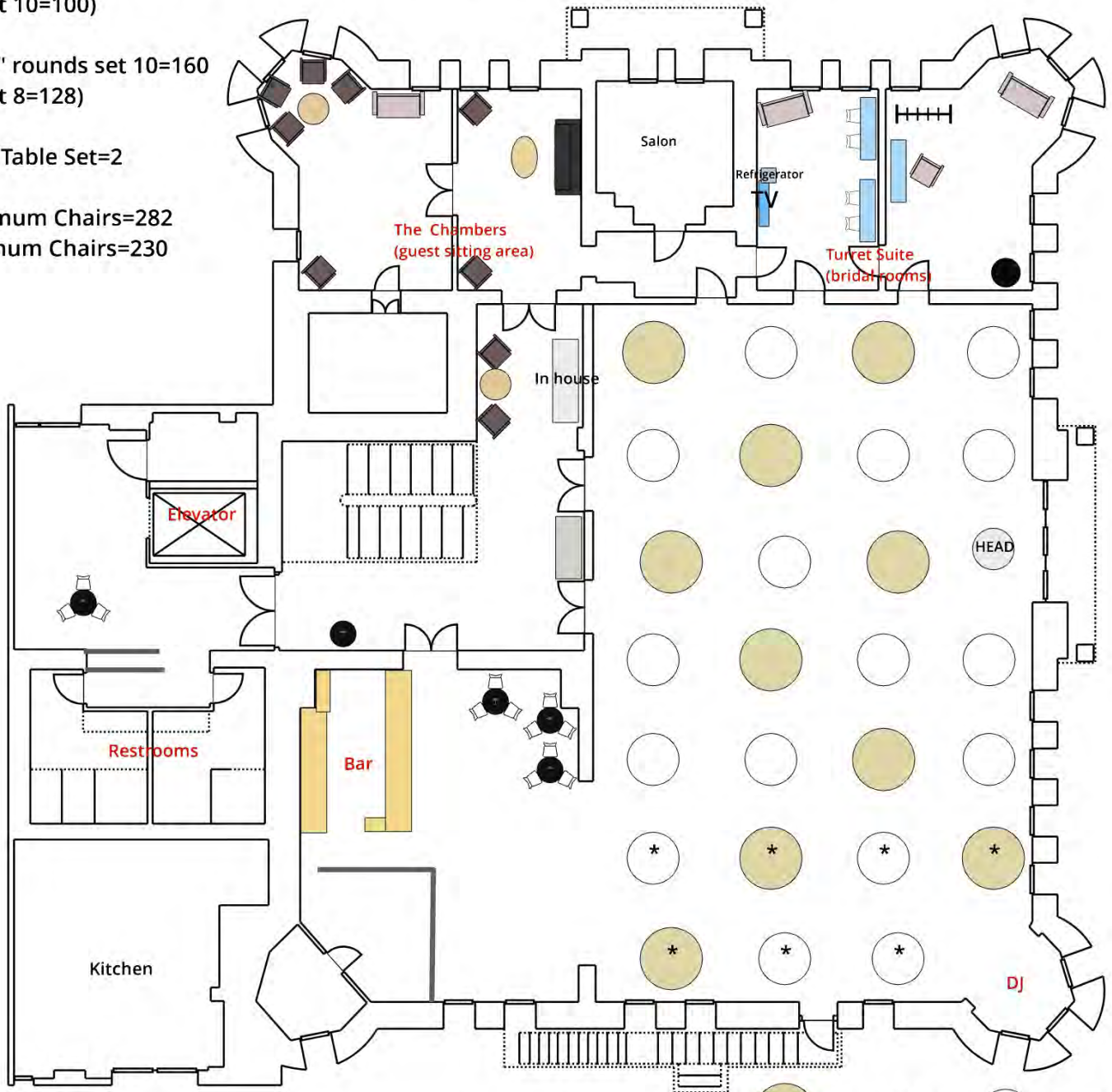

If 72" round is set for less than 10 chairs,
we will switch this to a 60" round

*Removed for dancing

 =Round 72"
(set 10-12)

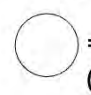
 =Round 60"
(set 8-10)

10 Feet

Tables may vary slightly from diagram for maximum comfort

8-72" rounds set 12=96
(or set 10=80)

9-60" rounds set 10=90
(or set 8=72)

Head Table set=14

Maximum Chairs=200
Minimum Chairs=166

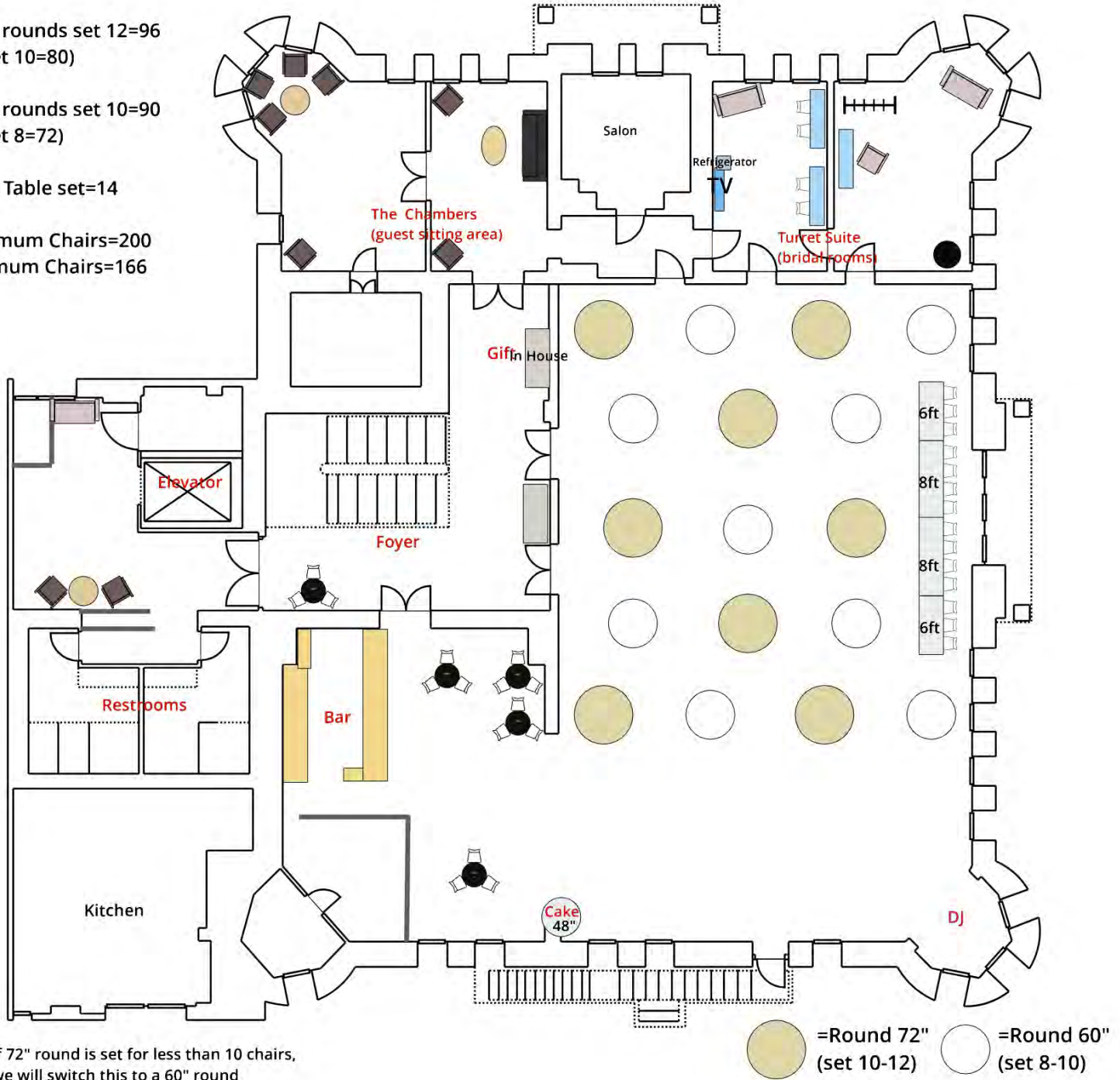

If 72" round is set for less than 10 chairs,
we will switch this to a 60" round

● =Round 72" (set 10-12) ○ =Round 60" (set 8-10)

10 Feet

Tables may vary slightly from diagram for maximum comfort

10-72" rounds set 12=120
(or set 10=100)

14-60" rounds set 10=140
(or set 8=112)

Head Table Set=12

Maximum Chairs=272
Minimum Chairs=224

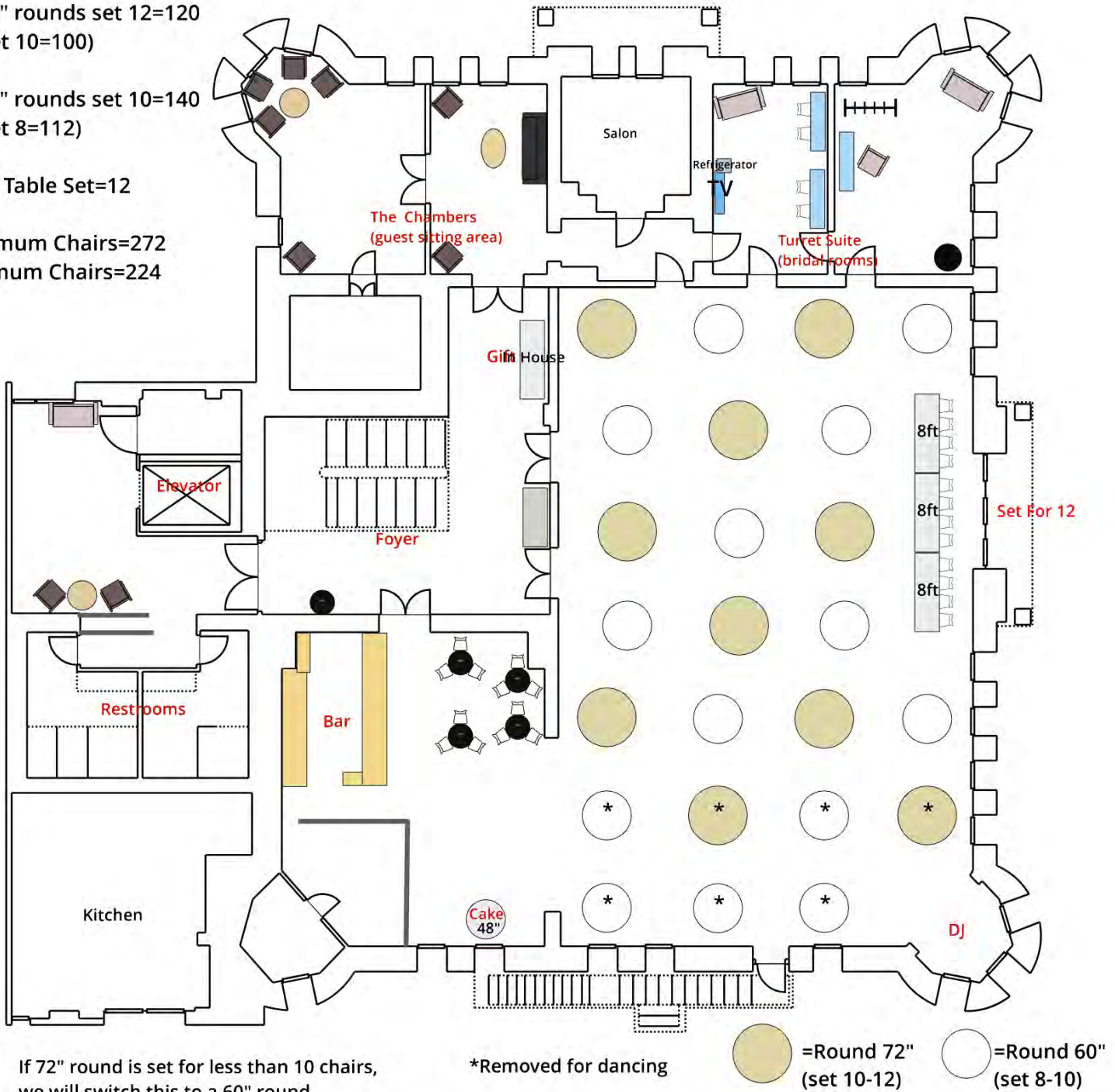

If 72" round is set for less than 10 chairs, we will switch this to a 60" round

*Removed for dancing

Green circle = Round 72" (set 10-12)
White circle = Round 60" (set 8-10)

10 Feet

Tables may vary slightly from diagram for maximum comfort

10-72" rounds set 12=120
(or set 10=100)

10-60" rounds set 10=100
(or set 8=80)

Head Table Set=18

Maximum Chairs=238
Minimum Chairs=198

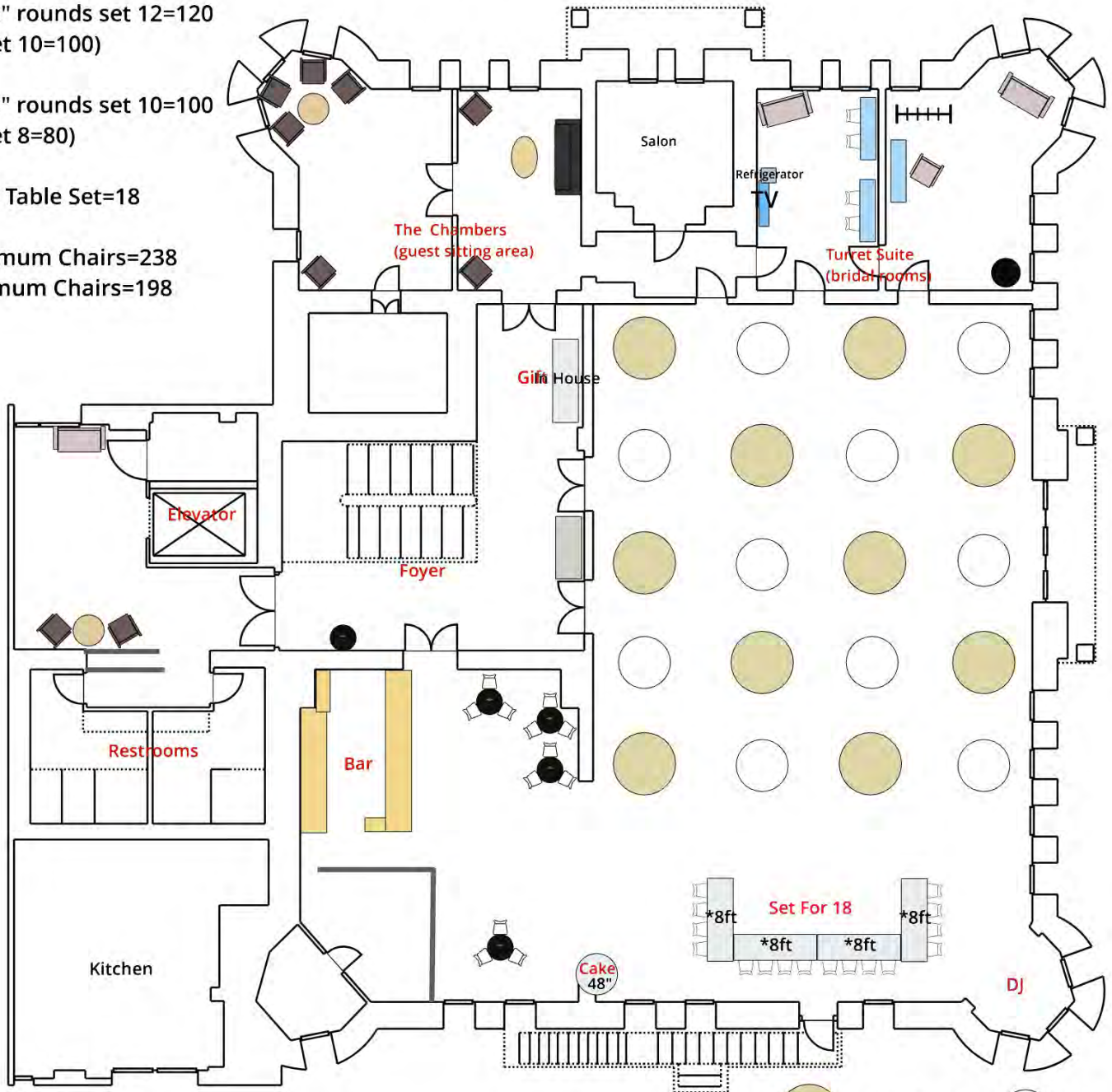

If 72" round is set for less than 10 chairs, we will switch this to a 60" round

*Removed for dancing

● =Round 72" (set 10-12)
○ =Round 60" (set 8-10)

10 Feet

Tables may vary slightly from diagram for maximum comfort

8-72" rounds set 12=96
(or set 10=80)

15-60" rounds set 10=150
(or set 8=120)

Head Table set=20

Maximum Chairs=266
Minimum Chairs=220

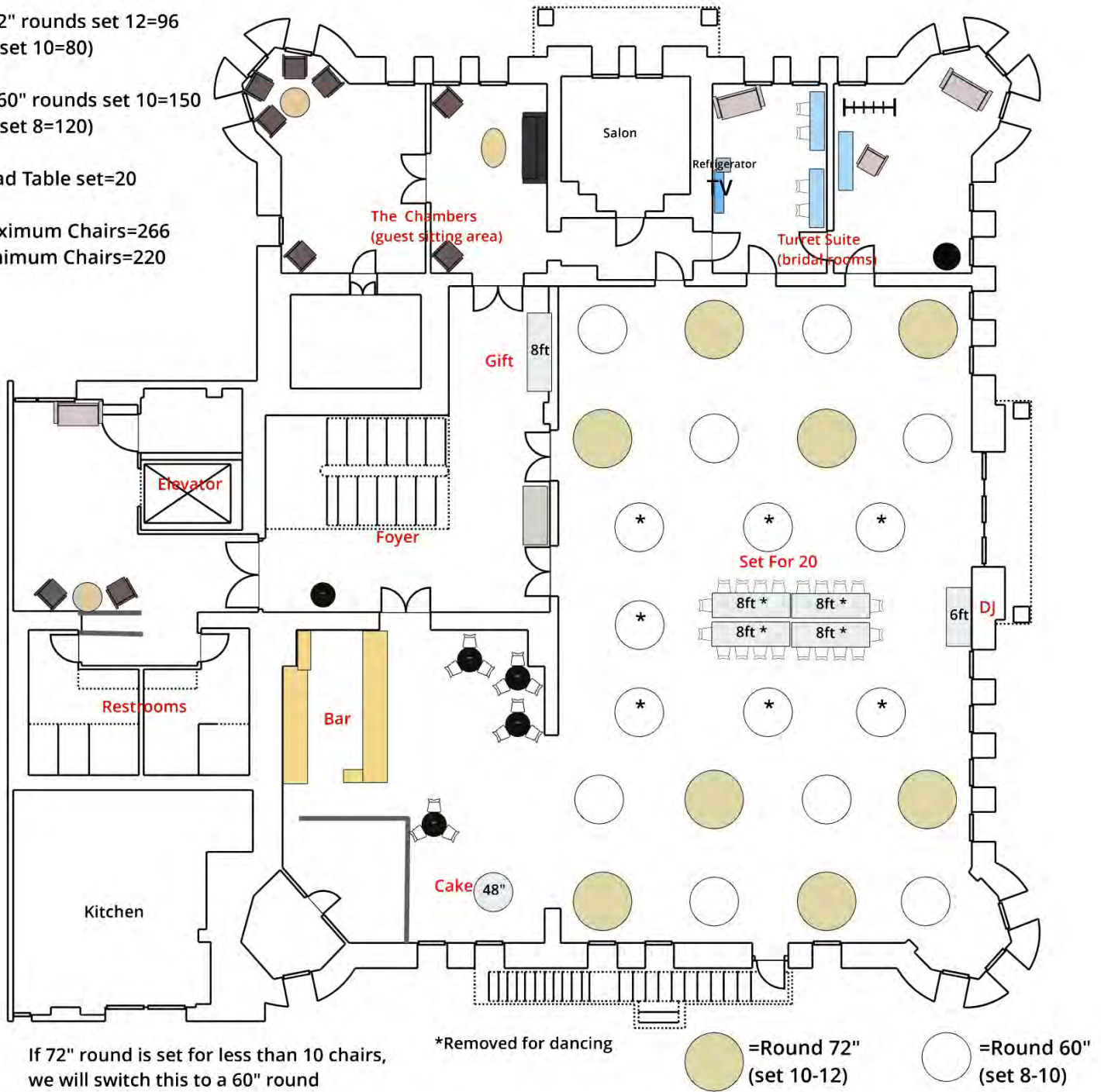

If 72" round is set for less than 10 chairs,
we will switch this to a 60" round

*Removed for dancing

 =Round 72"
(set 10-12)

 =Round 60"
(set 8-10)

10 Feet

Tables may vary slightly from diagram for maximum comfort

10-72" rounds set 12=120
(or set 10=100)

14-60" rounds set 10=140
(or set 8=112)

Head Table Set=8

Maximum Chairs=268
Minimum Chairs=220

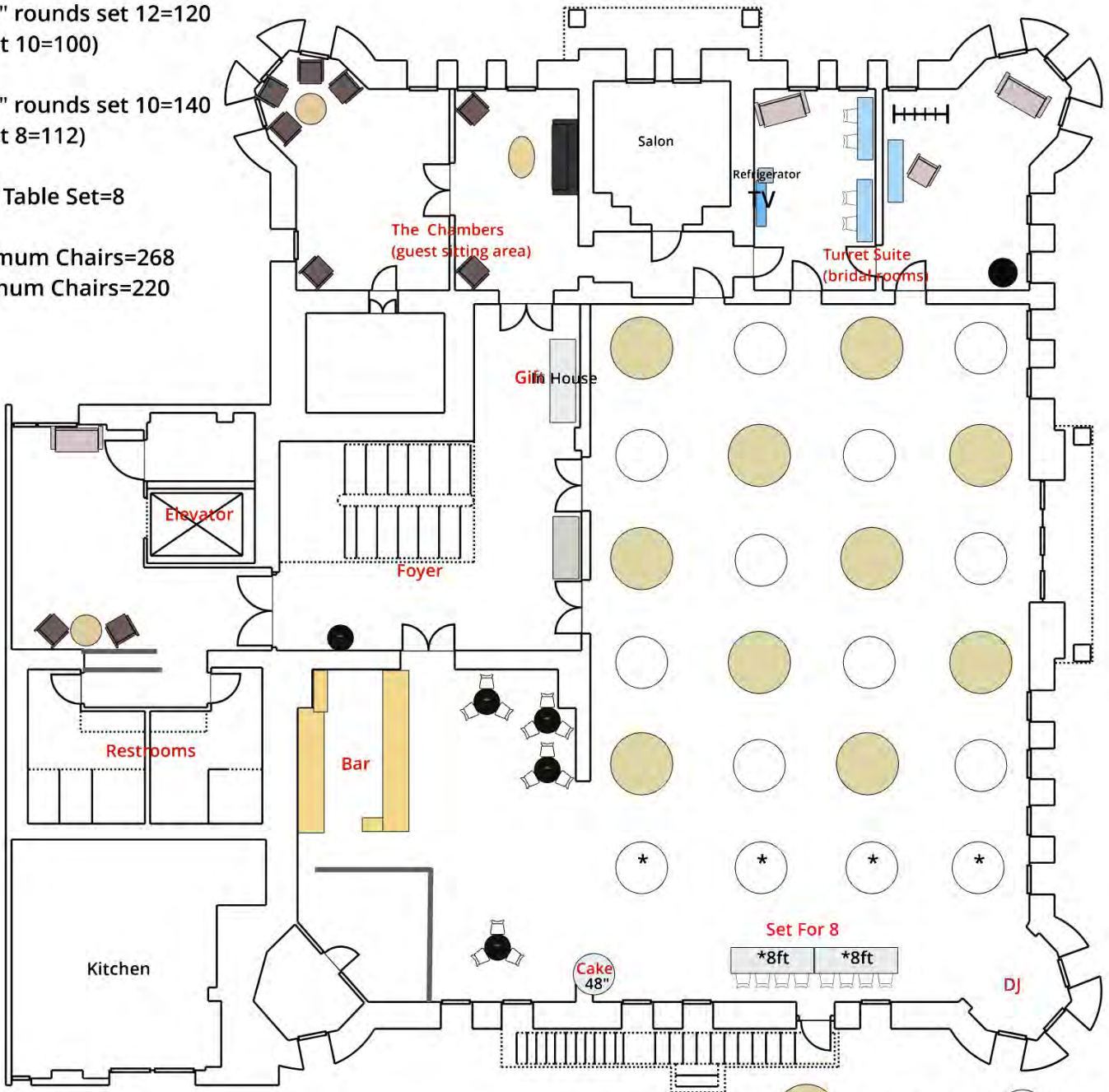

If 72" round is set for less than 10 chairs, we will switch this to a 60" round

*Remove for dancing

● =Round 72" (set 10-12)
○ =Round 60" (set 8-10)

Setup:

- 1) 5 1/2 chair wide in walkway. Single chairs spacing between Rows.
- 2) 1st Row back of chair starts at groom's side window
- 3) Maximum setup is 165 at 10 rows by various chairs

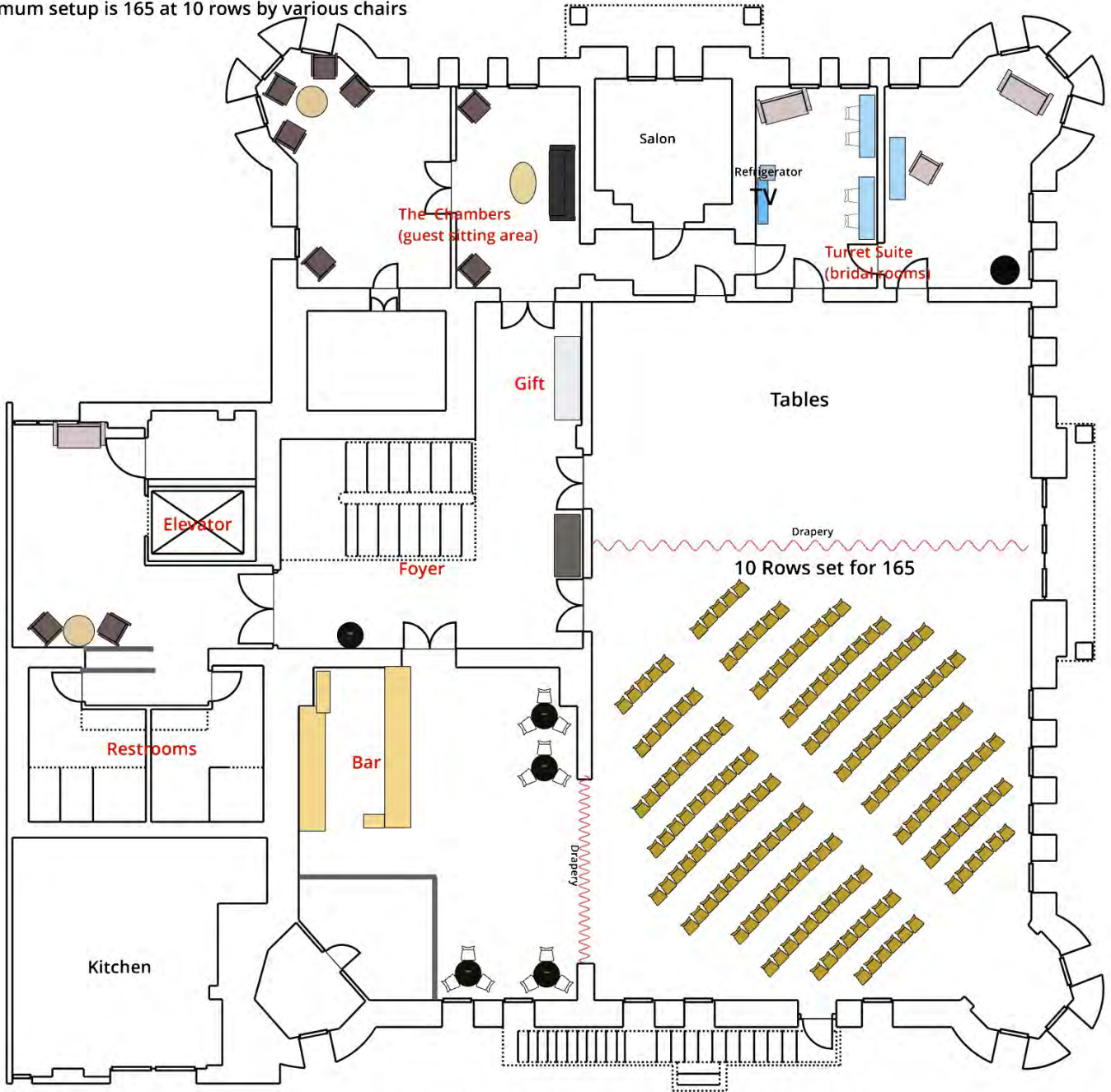

Chairs may vary slightly from diagram for maximum comfort

10 Feet

Tables may vary slightly from diagram for maximum comfort

8-60" rds set for 10=80
 6-72" rds set for 12=72

Head Table set =12

Total Chairs= 164

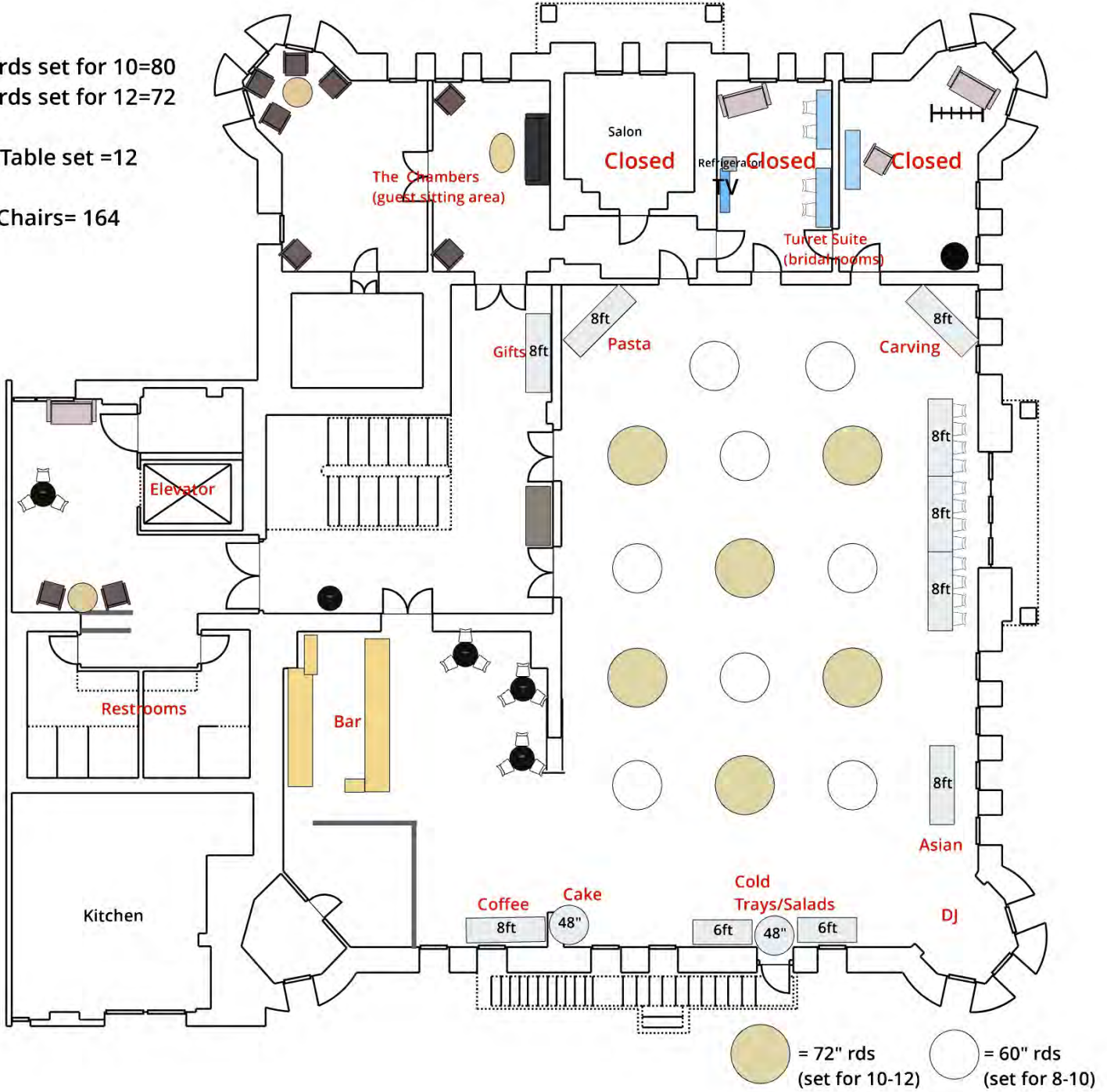

10 Feet

Tables may vary slightly from diagram for maximum comfort

10-72" rounds set 12=120
(or set 10=100)

11-60" rounds set 10=110
(or set 8=88)

Head Table set=14

Maximum Chairs=244
Minimum Chairs=202

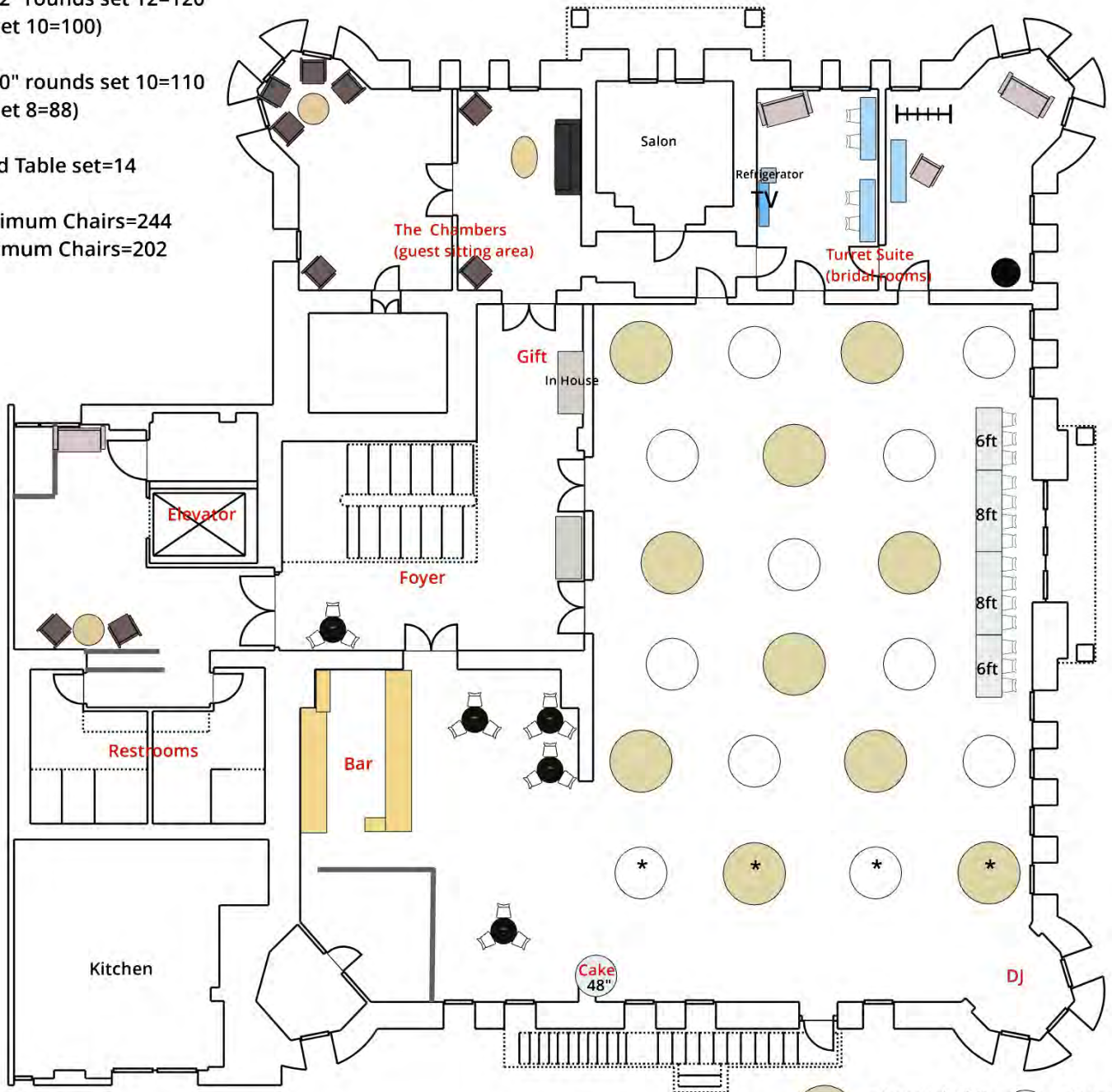

If 72" round is set for less than 10 chairs, we will switch this to a 60" round

*Removed for dancing

● =Round 72" (set 10-12) ○ =Round 60" (set 8-10)

10 Feet

Tables may vary slightly from diagram for maximum comfort

4-72" rounds set 12=48
(or set 10=40)

11-60" rounds set 10=110
(or set 8=88)

Head Table Set=18

Maximum Chairs=176
Minimum Chairs=146

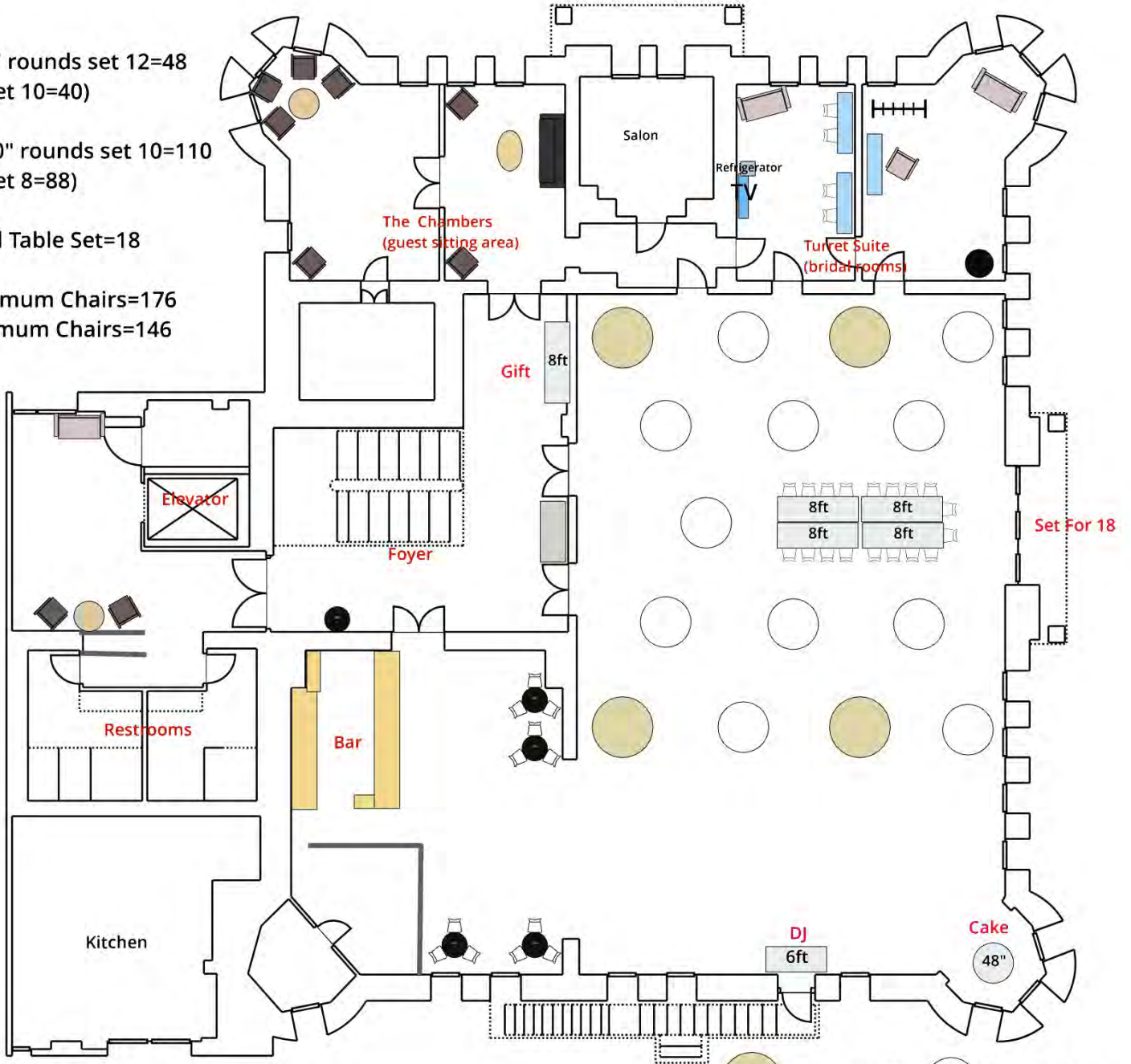

If 72" round is set for less than 10 chairs,
we will switch this to a 60" round

● =Round 72" (set 10-12) ○ =Round 60" (set 8-10)

10 Feet

Tables may vary slightly from diagram for maximum comfort

8-72" rounds set 12=96
(or set 10=80)

8-60" rounds set 10=80
(or set 8=64)

Head Table set=20

Maximum Chairs=196
Minimum Chairs=164

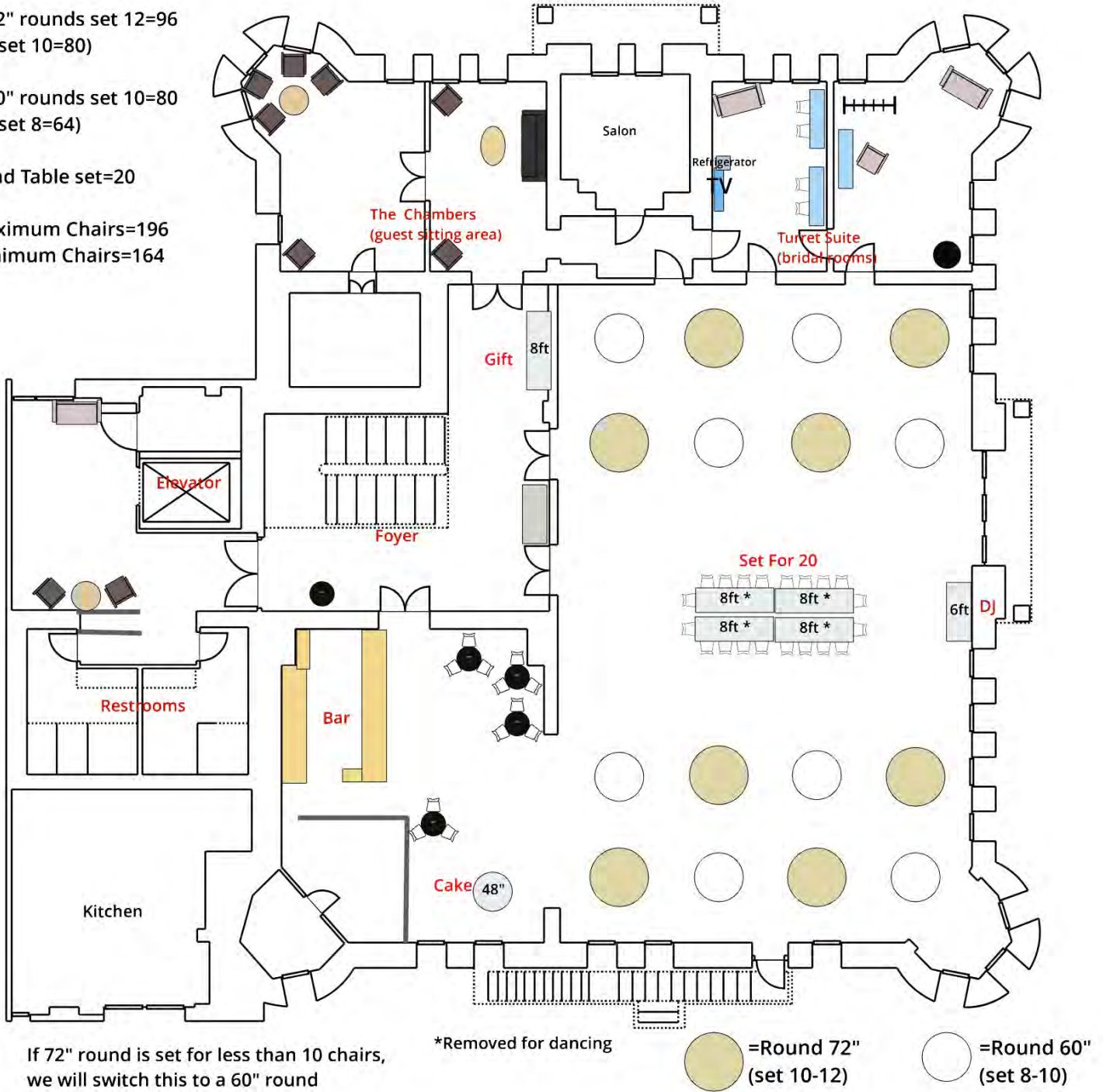

If 72" round is set for less than 10 chairs,
we will switch this to a 60" round

*Removed for dancing

● =Round 72"
(set 10-12)

○ =Round 60"
(set 8-10)

10 Feet

Tables may vary slightly from diagram for maximum comfort

10-72" rounds set 12=120
(or set 10=100)

18-60" rounds set 10=180
(or set 8=144)

Maximum Chairs=300
Minimum Chairs=244

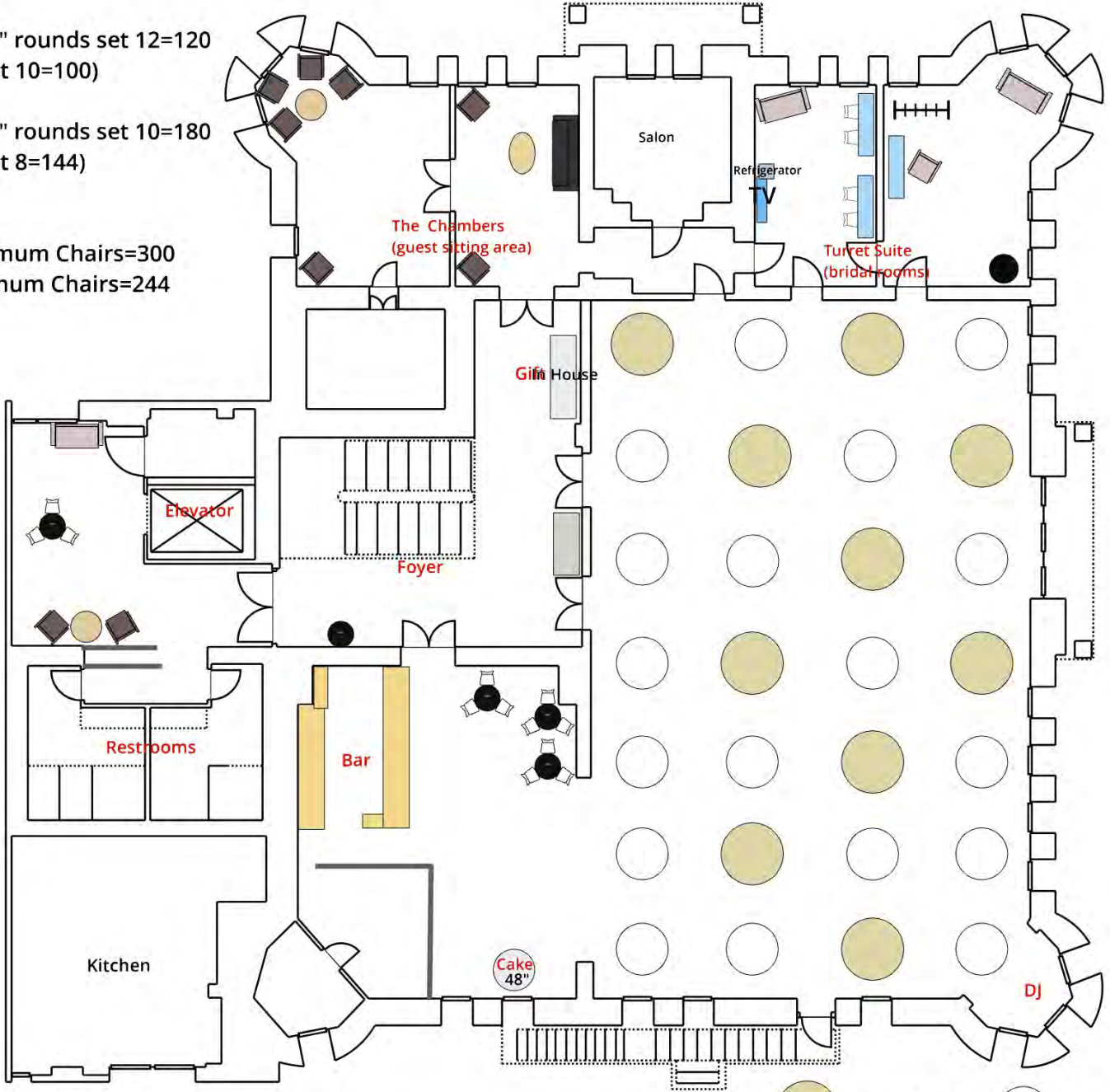

If 72" round is set for less than 10 chairs,
we will switch this to a 60" round

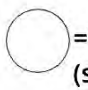
 =Round 72"
(set 10-12)  =Round 60"
(set 8-10)

10 Feet

Setup:

- 1) 5 1/2 chair wide in walkway. Single chairs spacing between Rows.
- 2) 1st Row back of chair starts edge of bridal doorway*.
- 3) Maximum setup is 234 at 10 rows by 12 chairs

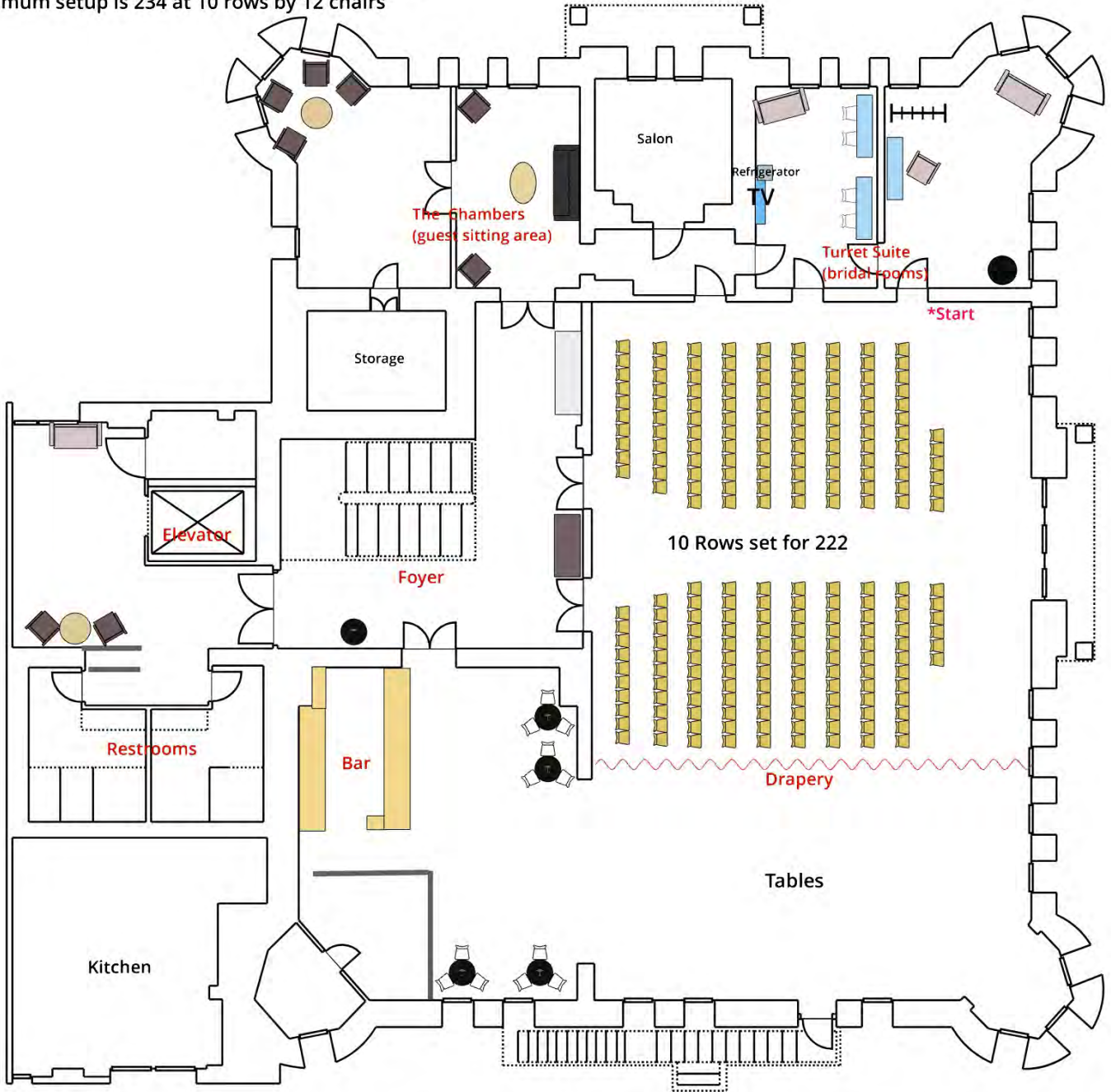

Chairs may vary slightly from diagram for maximum comfort

Setup:

- 1) 5 1/2 chair wide in aisle. 3 1/2 chair wide in walkway. Single chair spacing between Rows.
- 2) 1st Row starts at corner bar wall. 7 rows from 1st row to door-back of chair even with edge of door
- 3) 2nd set of Rows begin at door width
- 4) Maximum setup is 300 chairs at 15 Rows by 10 chairs.
- 5) HC1893 Blackout curtain and sheers for backdrop

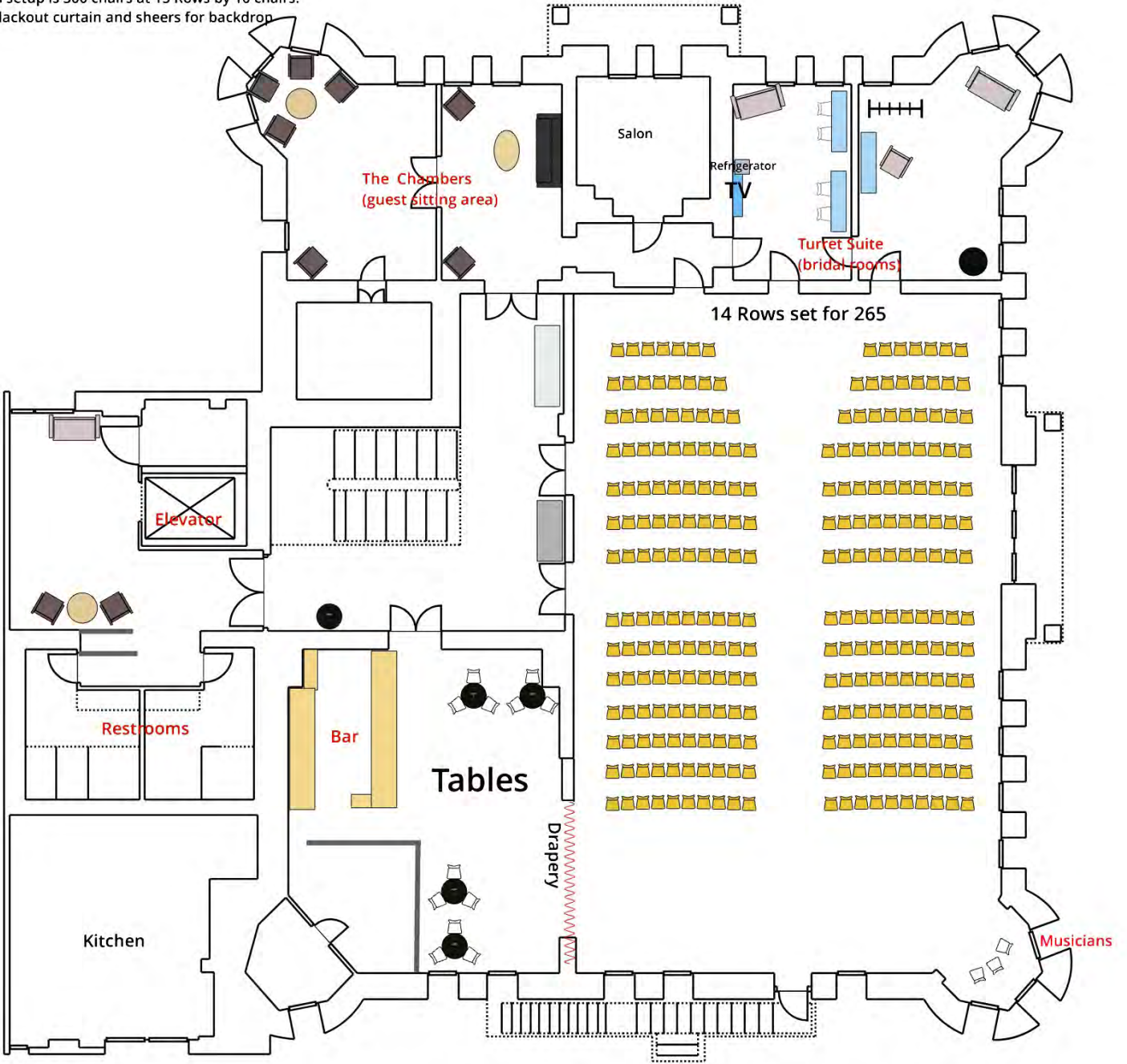

Chairs may vary slightly from diagram for maximum comfort

Setup:

- 1) 5 1/2 chair wide in aisle. 3 1/2 chair wide in walkway. Single chair spacing between Rows
- 2) 4 Rows up front. Back of chair even with edge of door.
- 3) 2nd section of rows begins at door width.
- 4) Maximum setup is 218 chairs at 11 rows by 10 chairs

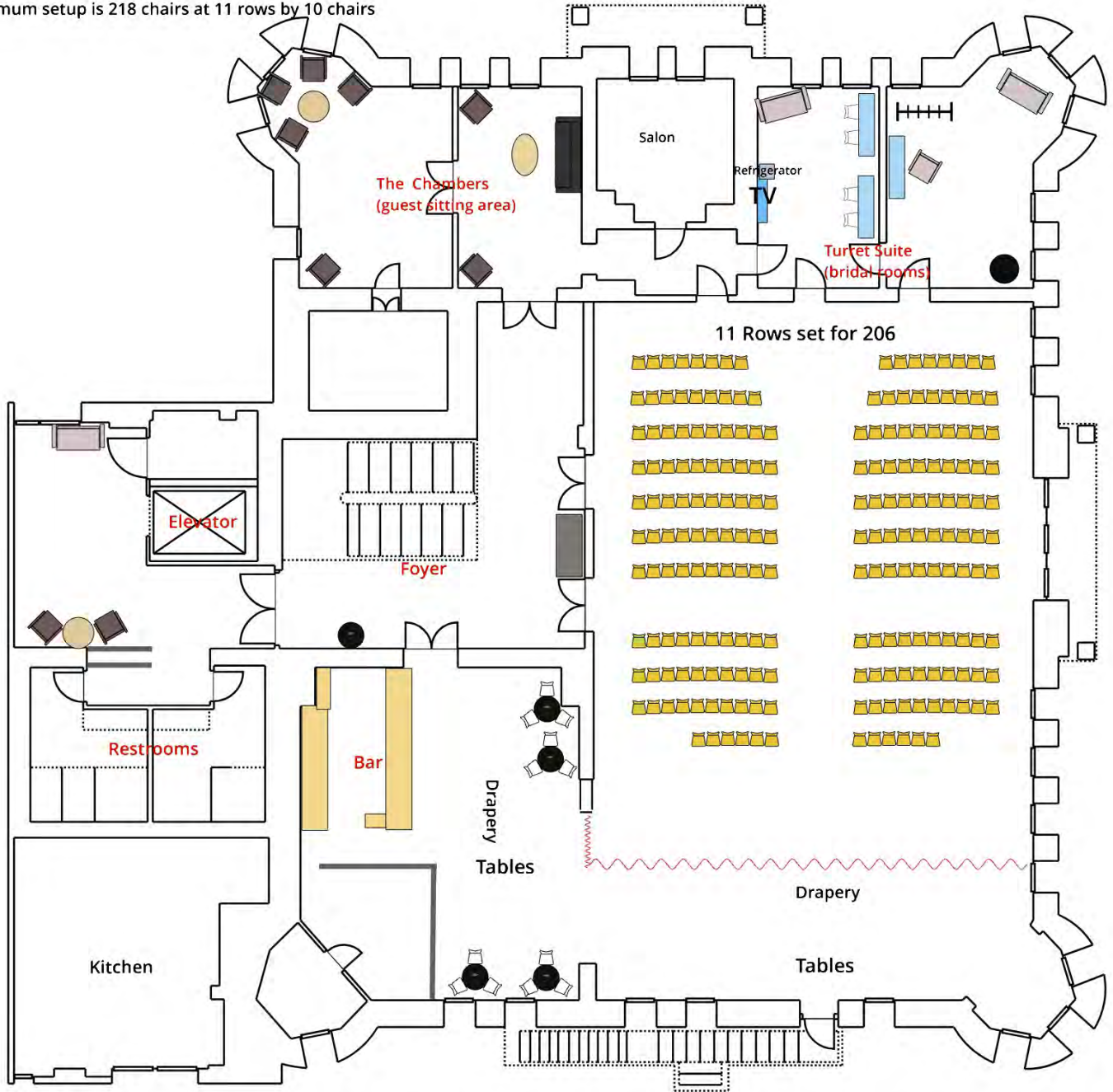

Chairs may vary slightly from diagram for maximum comfort

10 Feet